

Checked and found ok for Public Health (Internal) Service only subject to compliance in forwarding letter No. 265E(HQ) dated 08.07.77.
 Additional Chief Engineer (HQ) HSP, Panchkula

This is a "PROVISIONAL BUILDING PLAN" approved only for the purpose of inviting objections from the general public.

Ram Avtar Bansal
 AD(HQ)

P.A. A.T.P.

DDT (H) Member BPAC

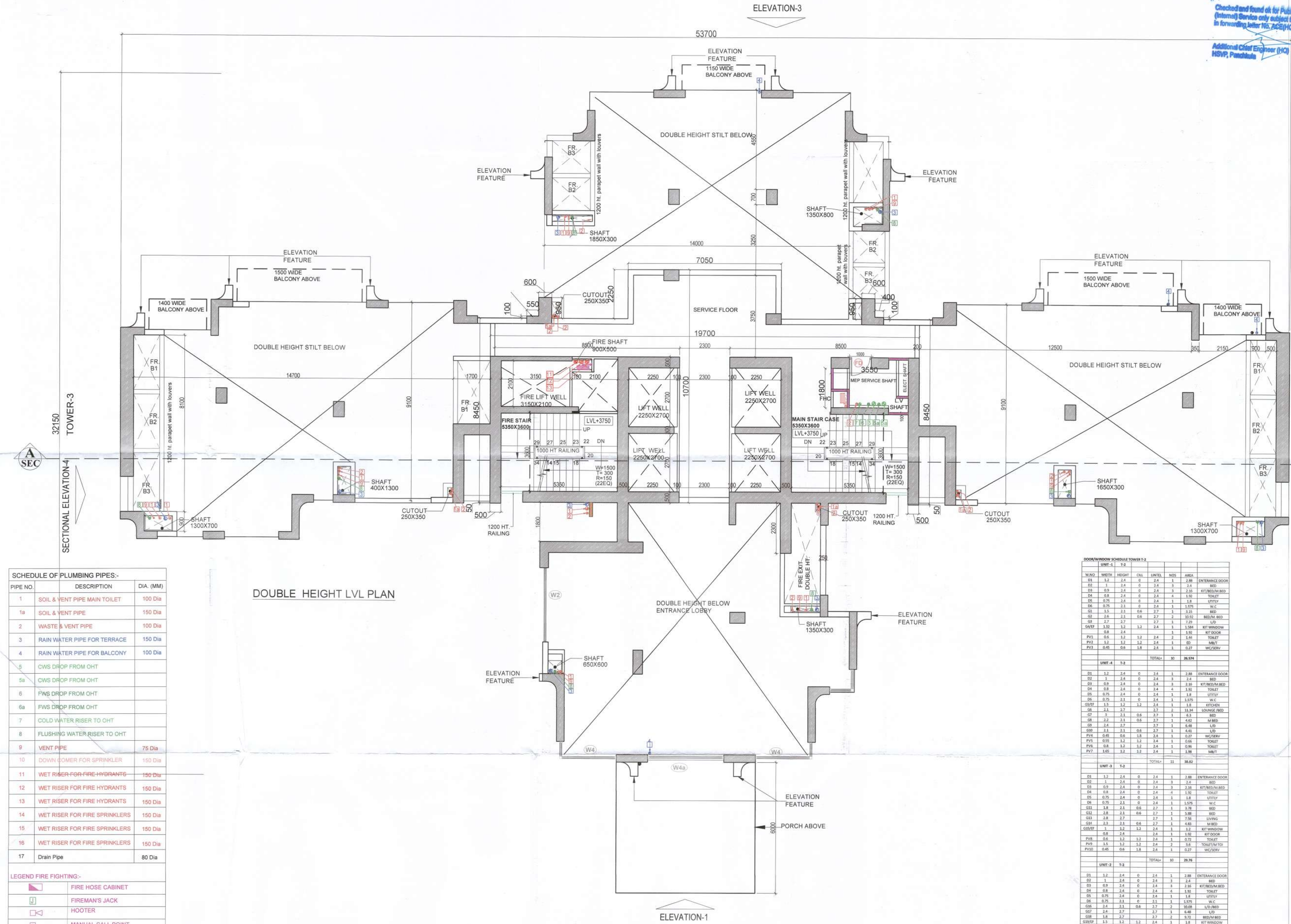

SCHEDULE OF PLUMBING PIPES:-

PIPE NO.	DESCRIPTION	DIA. (MM)
1	SOIL & VENT PIPE MAIN TOILET	100 Dia
1a	SOIL & VENT PIPE	150 Dia
2	WASTE & VENT PIPE	100 Dia
3	RAIN WATER PIPE FOR TERRACE	150 Dia
4	RAIN WATER PIPE FOR BALCONY	100 Dia
5	CWS DROP FROM OHT	
5a	CWS DROP FROM OHT	
6	FWS DROP FROM OHT	
6a	FWS DROP FROM OHT	
7	COLD WATER RISER TO OHT	
8	FLUSHING WATER RISER TO OHT	
9	VENT PIPE	75 Dia
10	DOWN COMER FOR SPRINKLER	150 Dia
11	WET RISER FOR FIRE HYDRANTS	150 Dia
12	WET RISER FOR FIRE HYDRANTS	150 Dia
13	WET RISER FOR FIRE HYDRANTS	150 Dia
14	WET RISER FOR FIRE SPRINKLERS	150 Dia
15	WET RISER FOR FIRE SPRINKLERS	150 Dia
16	WET RISER FOR FIRE SPRINKLERS	150 Dia
17	Drain Pipe	80 Dia

LEGEND FIRE FIGHTING:-

	FIRE HOSE CABINET
	FIREMAN'S JACK
	HOOTER
	MANUAL CALL POINT

LEGEND FIRE EXTINGUISHER

	FIRE EXTINGUISHER ABC POWDER TYPE - CAP. 6KG
	FIRE EXTINGUISHER BC POWDER TYPE - CAP. 6KG

NOTE: TOWERS SHALL BE PROVIDED WITH AUTOMATIC SPRINKLERS

DOUBLE HEIGHT LVL PLAN

DOOR/WINDOW SCHEDULE TOWER T-2

UNIT	WIND	WIDTH	HEIGHT	CILL	LINTEL	NOS.	AREA	REMARKS	
UNIT-1 T-2									
D1	1.2	2.4	0	2.4	1	2.88	ENTRANCE DOOR	RED	
D2	1	2.4	0	2.4	1	2.4	ENTRANCE DOOR	RED	
D3	0.9	2.4	0	2.4	1	2.16	KITCHEN/IN BED	RED	
D4	0.9	2.4	0	2.4	1	2.16	TOILET	RED	
D5	0.75	2.4	0	2.4	1	1.8	UTILITY	RED	
D6	0.75	2.4	0	2.4	1	1.8	W.C	RED	
D7	1.5	2.3	0.6	2.7	1	3.35	BED	RED	
D8	2.0	2.3	0.6	2.7	1	3.55	BED	RED	
D9	3.7	2.7	0	2.7	1	7.29	LID	RED	
D10	1.9	0.9	1.8	2.4	1	1.50	KIT WINDOW	RED	
D11	0.9	2.4	0	2.4	1	2.16	KIT WINDOW	RED	
D12	0.9	2.4	0	2.4	1	2.16	TOILET	RED	
D13	1.2	1.2	1.2	2.4	1	0.9	W.C	RED	
D14	0.45	0.6	1.8	2.4	1	0.37	W.C/SERV	RED	
TOTAL								30	36.32
UNIT-4 T-2									
D15	1.2	2.4	0	2.4	1	2.88	ENTRANCE DOOR	RED	
D16	1	2.4	0	2.4	1	2.4	ENTRANCE DOOR	RED	
D17	0.9	2.4	0	2.4	1	2.16	KITCHEN/IN BED	RED	
D18	0.9	2.4	0	2.4	1	2.16	TOILET	RED	
D19	0.75	2.4	0	2.4	1	1.8	UTILITY	RED	
D20	0.75	2.4	0	2.4	1	1.8	W.C	RED	
D21	1.5	1.2	1.2	2.4	1	1.8	KITCHEN	RED	
D22	2.0	1.2	1.2	2.4	1	1.8	LOUNGE/ BED	RED	
D23	1	2.1	0.6	2.7	1	4.41	RED	RED	
D24	2.2	2.1	0.6	2.7	1	4.41	M.BED	RED	
D25	2.4	2.7	0	2.7	1	6.48	LID	RED	
D26	2.4	2.1	0.6	2.7	1	4.41	LID	RED	
D27	1.9	0.9	1.8	2.4	1	1.50	W.C	RED	
D28	0.9	1.2	1.2	2.4	1	0.96	TOILET	RED	
D29	0.9	1.2	1.2	2.4	1	0.96	TOILET	RED	
D30	1.95	1.2	1.2	2.4	1	1.95	W.C	RED	
TOTAL								31	38.82
UNIT-3 T-2									
D31	1.2	2.4	0	2.4	1	2.88	ENTRANCE DOOR	RED	
D32	1	2.4	0	2.4	1	2.4	ENTRANCE DOOR	RED	
D33	0.9	2.4	0	2.4	1	2.16	KITCHEN/IN BED	RED	
D34	0.9	2.4	0	2.4	1	2.16	TOILET	RED	
D35	0.75	2.4	0	2.4	1	1.8	UTILITY	RED	
D36	0.75	2.4	0	2.4	1	1.8	W.C	RED	
D37	1.5	2.3	0.6	2.7	1	3.35	BED	RED	
D38	2.0	2.3	0.6	2.7	1	3.55	BED	RED	
D39	3.7	2.7	0	2.7	1	7.29	LID	RED	
D40	1.9	0.9	1.8	2.4	1	1.50	KIT WINDOW	RED	
D41	0.9	2.4	0	2.4	1	2.16	KIT WINDOW	RED	
D42	0.9	2.4	0	2.4	1	2.16	TOILET	RED	
D43	1.2	1.2	1.2	2.4	1	0.9	W.C	RED	
D44	0.45	0.6	1.8	2.4	1	0.37	W.C/SERV	RED	
TOTAL								31	38.82
UNIT-2 T-2									
D45	1.2	2.4	0	2.4	1	2.88	ENTRANCE DOOR	RED	
D46	1	2.4	0	2.4	1	2.4	ENTRANCE DOOR	RED	
D47	0.9	2.4	0	2.4	1	2.16	KITCHEN/IN BED	RED	
D48	0.9	2.4	0	2.4	1	2.16	TOILET	RED	
D49	0.75	2.4	0	2.4	1	1.8	UTILITY	RED	
D50	0.75	2.4	0	2.4	1	1.8	W.C	RED	
D51	1.5	2.3	0.6	2.7	1	3.35	BED	RED	
D52	2.0	2.3	0.6	2.7	1	3.55	BED	RED	
D53	3.7	2.7	0	2.7	1	7.29	LID	RED	
D54	1.9	0.9	1.8	2.4	1	1.50	KIT WINDOW	RED	
D55	0.9	2.4	0	2.4	1	2.16	KIT WINDOW	RED	
D56	0.9	2.4	0	2.4	1	2.16	TOILET	RED	
D57	1.2	1.2	1.2	2.4	1	0.9	W.C	RED	
D58	0.45	0.6	1.8	2.4	1	0.37	W.C/SERV	RED	
TOTAL								31	38.82
COMMON AREA T-2									
D59	1	2.1	0	2	1	2.1	SERVICES	RED	
D60	1.5	1.1	0	2	1	2.31	MAIN/FIRE STAIR	RED	
D61	1.5	2.1	0	2	1	2.31	FIRE LOBBY	RED	
D62	1	2.75	0	2	1	2.75	MAIN/FIRE STAIR	RED	
D63	1.5	1.5	1.2	1.7	1	2.25	CORRIDOR	RED	
D64	1.4	3.5	1.2	3.7	1	3.3	CORRIDOR	RED	
TOTAL								7	16.57

GROUND/UPPER DUPLEX T-2

W. NO.	WIDTH	HEIGHT	CILL	LINTEL	N. NOS.
W1	2.05+0.25	3.4	0.1	5.5	2
DW	0.5+2.4+0.5	5.4	0.1	5.5	3
W2	3.4	5.4	0.1	5.5	1
W3	1.15+1.7	3.9	0.1	4	2
W4	1.15	1.05	0.1	4	1
TOTAL					7

NOTE: D1 (UNIT ENTRY DOOR IS 1HR FIRE RATED)



For VIPUL LIMITED
 Authorised Signatory