

This is a \*PROVISIONAL BUILDING PLAN approved only for the purpose of inviting objections from the general public

Checked and found ok for Public Health (Internal) Service only subject to comments in forwarding letter No. ACE(HQ) 68277  
Additional Chief Engineer (H.O) HSWP, Panchkula

Member Secretary BAC  
Member Secretary BAC  
AD(HQ)  
P.A.  
A.T.P.

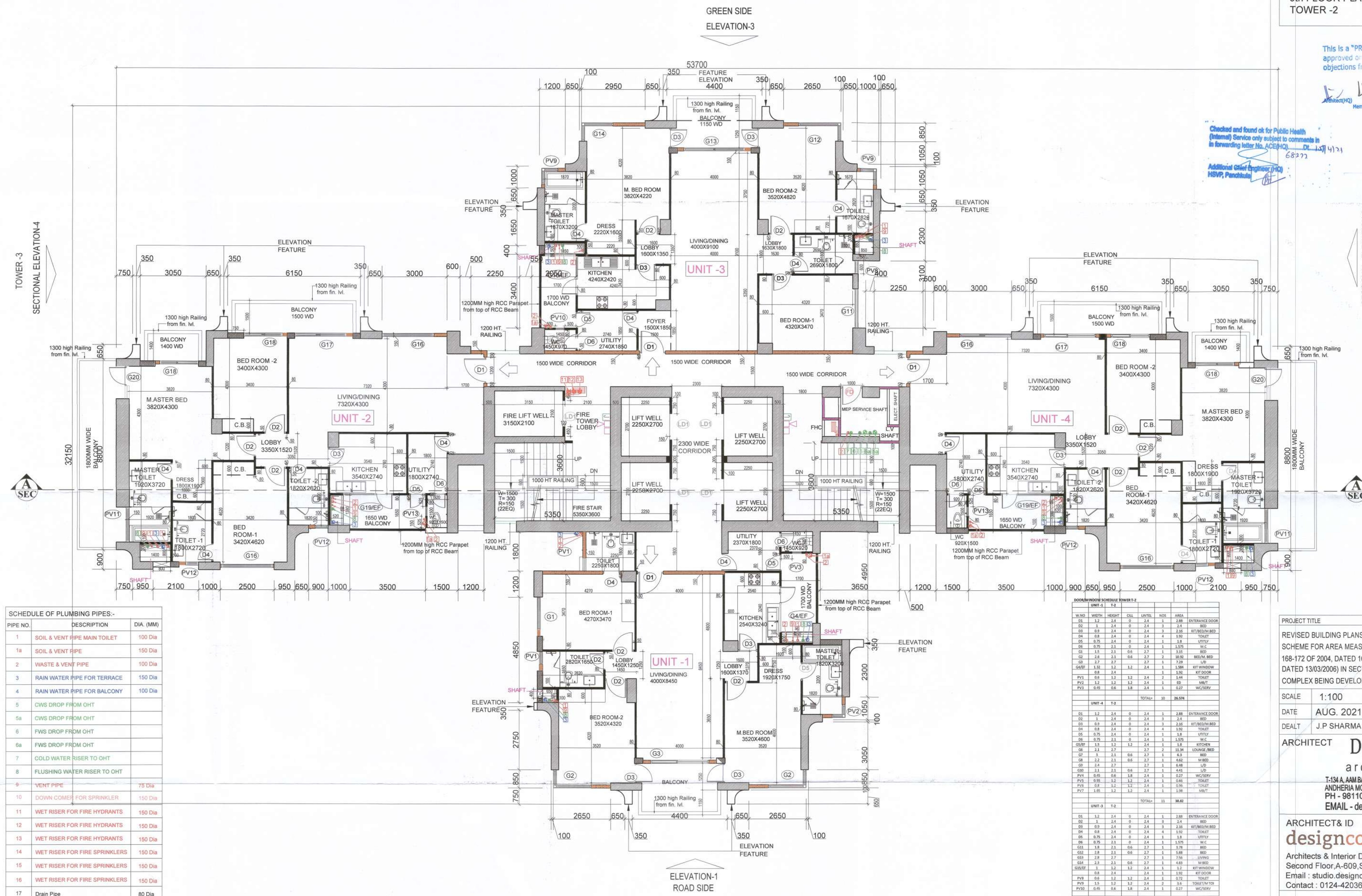

**SCHEDULE OF PLUMBING PIPES:-**

PIPE NO.	DESCRIPTION	DIA. (MM)
1	SOIL & VENT PIPE MAIN TOILET	100 Dia
1A	SOIL & VENT PIPE	150 Dia
2	WASTE & VENT PIPE	100 Dia
3	RAIN WATER PIPE FOR TERRACE	150 Dia
4	RAIN WATER PIPE FOR BALCONY	100 Dia
5	CWS DROP FROM OHT	
5a	CWS DROP FROM OHT	
6	FWS DROP FROM OHT	
6a	FWS DROP FROM OHT	
7	COLD WATER RISER TO OHT	
8	FLUSHING WATER RISER TO OHT	
9	VENT PIPE	75 Dia
10	DOWN COMER FOR SPRINKLER	150 Dia
11	WET RISER FOR FIRE HYDRANTS	150 Dia
12	WET RISER FOR FIRE HYDRANTS	150 Dia
13	WET RISER FOR FIRE HYDRANTS	150 Dia
14	WET RISER FOR FIRE SPRINKLERS	150 Dia
15	WET RISER FOR FIRE SPRINKLERS	150 Dia
16	WET RISER FOR FIRE SPRINKLERS	150 Dia
17	Drain Pipe	80 Dia

**LEGEND FIRE FIGHTING:-**

- FIRE HOSE CABINET
- FIREMAN'S JACK
- HOOTER
- MANUAL CALL POINT

**LEGEND FIRE EXTINGUISHER**

- FIRE EXTINGUISHER ABC POWDER TYPE - CAP. 6KG.
- FIRE EXTINGUISHER BC POWDER TYPE - CAP. 9KG.

**NOTE**  
TOWERS SHALL BE PROVIDED WITH AUTOMATIC SPRINKLERS

**ROOM/WINDOW SCHEDULE TOWER-2**

UNIT	W.NO.	WIDTH	HEIGHT	CELL	LEVEL	NO.	AREA	ENTRANCE
<b>UNIT-1 T-2</b>								
D1	1.2	2.4	0	2.4	1	2.88		ENTRANCE DOOR
D2	1.2	2.4	0	2.4	1	2.88		W.C.
D3	0.9	2.4	0	2.4	1	2.16		ENTRANCE DOOR
D4	0.8	2.4	0	2.4	1	1.92		TOILET
D5	0.75	2.4	0	2.4	1	1.80		W.C.
D6	0.75	2.4	0	2.4	1	1.80		W.C.
D7	2.4	2.4	0	2.4	1	15.55		W.C.
D8	1.5	1.2	1.2	2.4	1	1.80		ENTRANCE DOOR
D9	1.5	1.2	1.2	2.4	1	1.80		ENTRANCE DOOR
D10	1.5	1.2	1.2	2.4	1	1.80		ENTRANCE DOOR
D11	1.5	1.2	1.2	2.4	1	1.80		ENTRANCE DOOR
D12	1.5	1.2	1.2	2.4	1	1.80		ENTRANCE DOOR
D13	1.5	1.2	1.2	2.4	1	1.80		ENTRANCE DOOR
D14	1.5	1.2	1.2	2.4	1	1.80		ENTRANCE DOOR
D15	1.5	1.2	1.2	2.4	1	1.80		ENTRANCE DOOR
D16	1.5	1.2	1.2	2.4	1	1.80		ENTRANCE DOOR
D17	1.5	1.2	1.2	2.4	1	1.80		ENTRANCE DOOR
D18	1.5	1.2	1.2	2.4	1	1.80		ENTRANCE DOOR
D19	1.5	1.2	1.2	2.4	1	1.80		ENTRANCE DOOR
D20	1.5	1.2	1.2	2.4	1	1.80		ENTRANCE DOOR
D21	1.5	1.2	1.2	2.4	1	1.80		ENTRANCE DOOR
D22	1.5	1.2	1.2	2.4	1	1.80		ENTRANCE DOOR
D23	1.5	1.2	1.2	2.4	1	1.80		ENTRANCE DOOR
D24	1.5	1.2	1.2	2.4	1	1.80		ENTRANCE DOOR
D25	1.5	1.2	1.2	2.4	1	1.80		ENTRANCE DOOR
D26	1.5	1.2	1.2	2.4	1	1.80		ENTRANCE DOOR
D27	1.5	1.2	1.2	2.4	1	1.80		ENTRANCE DOOR
D28	1.5	1.2	1.2	2.4	1	1.80		ENTRANCE DOOR
D29	1.5	1.2	1.2	2.4	1	1.80		ENTRANCE DOOR
D30	1.5	1.2	1.2	2.4	1	1.80		ENTRANCE DOOR
D31	1.5	1.2	1.2	2.4	1	1.80		ENTRANCE DOOR
D32	1.5	1.2	1.2	2.4	1	1.80		ENTRANCE DOOR
D33	1.5	1.2	1.2	2.4	1	1.80		ENTRANCE DOOR
D34	1.5	1.2	1.2	2.4	1	1.80		ENTRANCE DOOR
D35	1.5	1.2	1.2	2.4	1	1.80		ENTRANCE DOOR
D36	1.5	1.2	1.2	2.4	1	1.80		ENTRANCE DOOR
D37	1.5	1.2	1.2	2.4	1	1.80		ENTRANCE DOOR
D38	1.5	1.2	1.2	2.4	1	1.80		ENTRANCE DOOR
D39	1.5	1.2	1.2	2.4	1	1.80		ENTRANCE DOOR
D40	1.5	1.2	1.2	2.4	1	1.80		ENTRANCE DOOR
D41	1.5	1.2	1.2	2.4	1	1.80		ENTRANCE DOOR
D42	1.5	1.2	1.2	2.4	1	1.80		ENTRANCE DOOR
D43	1.5	1.2	1.2	2.4	1	1.80		ENTRANCE DOOR
D44	1.5	1.2	1.2	2.4	1	1.80		ENTRANCE DOOR
D45	1.5	1.2	1.2	2.4	1	1.80		ENTRANCE DOOR
D46	1.5	1.2	1.2	2.4	1	1.80		ENTRANCE DOOR
D47	1.5	1.2	1.2	2.4	1	1.80		ENTRANCE DOOR
D48	1.5	1.2	1.2	2.4	1	1.80		ENTRANCE DOOR
D49	1.5	1.2	1.2	2.4	1	1.80		ENTRANCE DOOR
D50	1.5	1.2	1.2	2.4	1	1.80		ENTRANCE DOOR
D51	1.5	1.2	1.2	2.4	1	1.80		ENTRANCE DOOR
D52	1.5	1.2	1.2	2.4	1	1.80		ENTRANCE DOOR
D53	1.5	1.2	1.2	2.4	1	1.80		ENTRANCE DOOR
D54	1.5	1.2	1.2	2.4	1	1.80		ENTRANCE DOOR
D55	1.5	1.2	1.2	2.4	1	1.80		ENTRANCE DOOR
D56	1.5	1.2	1.2	2.4	1	1.80		ENTRANCE DOOR
D57	1.5	1.2	1.2	2.4	1	1.80		ENTRANCE DOOR
D58	1.5	1.2	1.2	2.4	1	1.80		ENTRANCE DOOR
D59	1.5	1.2	1.2	2.4	1	1.80		ENTRANCE DOOR
D60	1.5	1.2	1.2	2.4	1	1.80		ENTRANCE DOOR
D61	1.5	1.2	1.2	2.4	1	1.80		ENTRANCE DOOR
D62	1.5	1.2	1.2	2.4	1	1.80		ENTRANCE DOOR
D63	1.5	1.2	1.2	2.4	1	1.80		ENTRANCE DOOR
D64	1.5	1.2	1.2	2.4	1	1.80		ENTRANCE DOOR
D65	1.5	1.2	1.2	2.4	1	1.80		ENTRANCE DOOR
D66	1.5	1.2	1.2	2.4	1	1.80		ENTRANCE DOOR
D67	1.5	1.2	1.2	2.4	1	1.80		ENTRANCE DOOR
D68	1.5	1.2	1.2	2.4	1	1.80		ENTRANCE DOOR
D69	1.5	1.2	1.2	2.4	1	1.80		ENTRANCE DOOR
D70	1.5	1.2	1.2	2.4	1	1.80		ENTRANCE DOOR
D71	1.5	1.2	1.2	2.4	1	1.80		ENTRANCE DOOR
D72	1.5	1.2	1.2	2.4	1	1.80		ENTRANCE DOOR
D73	1.5	1.2	1.2	2.4	1	1.80		ENTRANCE DOOR
D74	1.5	1.2	1.2	2.4	1	1.80		ENTRANCE DOOR
D75	1.5	1.2	1.2	2.4	1	1.80		ENTRANCE DOOR
D76	1.5	1.2	1.2	2.4	1	1.80		ENTRANCE DOOR
D77	1.5	1.2	1.2	2.4	1	1.80		ENTRANCE DOOR
D78	1.5	1.2	1.2	2.4	1	1.80		ENTRANCE DOOR
D79	1.5	1.2	1.2	2.4	1	1.80		ENTRANCE DOOR
D80	1.5	1.2	1.2	2.4	1	1.80		ENTRANCE DOOR
D81	1.5	1.2	1.2	2.4	1	1.80		ENTRANCE DOOR
D82	1.5	1.2	1.2	2.4	1	1.80		ENTRANCE DOOR
D83	1.5	1.2	1.2	2.4	1	1.80		ENTRANCE DOOR
D84	1.5	1.2	1.2	2.4	1	1.80		ENTRANCE DOOR
D85	1.5	1.2	1.2	2.4	1	1.80		ENTRANCE DOOR
D86	1.5	1.2	1.2	2.4	1	1.80		ENTRANCE DOOR
D87	1.5	1.2	1.2	2.4	1	1.80		ENTRANCE DOOR
D88	1.5	1.2	1.2	2.4	1	1.80		ENTRANCE DOOR
D89	1.5	1.2	1.2	2.4	1	1.80		ENTRANCE DOOR
D90	1.5	1.2	1.2	2.4	1	1.80		ENTRANCE DOOR
D91	1.5	1.2	1.2	2.4	1	1.80		ENTRANCE DOOR
D92	1.5	1.2	1.2	2.4	1	1.80		ENTRANCE DOOR
D93	1.5	1.2	1.2	2.4	1	1.80		ENTRANCE DOOR
D94	1.5	1.2	1.2	2.4	1	1.80		ENTRANCE DOOR
D95	1.5	1.2	1.2	2.4	1	1.80		ENTRANCE DOOR
D96	1.5	1.2	1.2	2.4	1	1.80		ENTRANCE DOOR
D97	1.5	1.2	1.2	2.4	1	1.80		ENTRANCE DOOR
D98	1.5	1.2	1.2	2.4	1	1.80		ENTRANCE DOOR
D99	1.5	1.2	1.2	2.4	1	1.80		ENTRANCE DOOR
D100	1.5	1.2	1.2	2.4	1	1.80		ENTRANCE DOOR
D101	1.5	1.2	1.2	2.4	1	1.80		ENTRANCE DOOR
D102	1.5	1.2	1.2	2.4	1	1.80		ENTRANCE DOOR
D103	1.5	1.2	1.2	2.4	1	1.80		ENTRANCE DOOR
D104	1.5	1.2	1.2	2.4	1	1.80		ENTRANCE DOOR
D105	1.5	1.2	1.2	2.4	1	1.80		ENTRANCE DOOR
D106	1.5	1.2	1.2	2.4	1	1.80		ENTRANCE DOOR
D107	1.5	1.2	1.2	2.4	1	1.80		ENTRANCE DOOR
D108	1.5	1.2	1.2	2.4	1	1.80		ENTRANCE DOOR
D109	1.5	1.2	1.2	2.4	1	1.80		ENTRANCE DOOR
D110	1.5	1.2	1.2	2.4	1	1.80		ENTRANCE DOOR
D111	1.5	1.2	1.2	2.4	1	1.80		ENTRANCE DOOR
D112	1.5	1.2	1.2	2.4	1	1.80		ENTRANCE DOOR
D113	1.5	1.2	1.2	2.4	1	1.80		ENTRANCE DOOR
D114	1.5	1.2	1.2	2.4	1	1.80		ENTRANCE DOOR
D115	1.5	1.2	1.2	2.4	1	1.80		ENTRANCE DOOR
D116	1.5	1.2	1.2	2.4	1	1.80		ENTRANCE DOOR
D117	1.5	1.2	1.2	2.4	1	1.80		ENTRANCE DOOR
D118	1.5	1.2	1.2	2.4	1	1.80		ENTRANCE DOOR
D119	1.5	1.2	1.2	2.4	1	1.80		ENTRANCE DOOR
D120	1.5	1.2	1.2	2.4	1	1.80		ENTRANCE DOOR
D121	1.5	1.2	1.2	2.4	1	1.80		ENTRANCE DOOR
D122	1.5	1.2	1.2	2.4	1	1.80		ENTRANCE DOOR
D123	1.5	1.2	1.2	2.4	1	1.80		ENTRANCE DOOR
D124	1.5	1.2	1.2	2.4	1	1.80		ENTRANCE DOOR
D125	1.5	1.2	1.2	2.4	1	1.80		ENTRANCE DOOR
D126	1.5	1.2	1.2	2.4	1	1.80		ENTRANCE DOOR
D127	1.5	1.2	1.2	2.4	1	1.80		ENTRANCE DOOR
D128	1.5	1.2	1.2	2.4	1	1.80		ENTRANCE DOOR
D129	1.5	1.2	1.2	2.4	1	1.80		ENTRANCE DOOR
D130	1.5	1.2	1.2	2.4	1	1.80		ENTRANCE DOOR
D131	1.5	1.2	1.2	2.4	1	1.80		ENTRANCE DOOR
D132	1.5	1.2	1.2	2.4	1	1.80		ENTRANCE DOOR
D133	1.5	1.2	1.2	2.4	1	1.80		ENTRANCE DOOR
D134	1.5	1.2	1.2	2.4	1	1.80		ENTRANCE DOOR
D135	1.5	1.2	1.2	2.4	1	1.80		ENTRANCE DOOR
D136	1.5	1.2	1.2	2.4	1	1.80		ENTRANCE DOOR
D137	1.5	1.2	1.2	2.4	1	1.80		ENTRANCE DOOR
D138	1.5	1.2	1.2	2.4	1	1.80		ENTRANCE DOOR
D139	1.5	1.2	1.2	2.4	1	1.80		ENTRANCE DOOR
D140	1.5	1.2	1.2	2.4	1	1.80		ENTRANCE DOOR
D141	1.5	1.2	1.2	2.4	1	1.80		ENTRANCE DOOR
D142	1.5	1.2	1.2	2.4	1	1.80		ENTRANCE DOOR
D143	1.5	1.2	1.2	2.4	1	1.80		ENTRANCE DOOR
D144	1.5	1.2	1.2	2.4	1	1.80		ENTRANCE DOOR
D145	1.5	1.2	1.2	2.4	1	1.80		ENTRANCE DOOR
D146	1.5	1.2	1.2	2.4	1	1.80		ENTRANCE DOOR
D147	1.5	1.2	1.2	2.4	1	1.80		ENTRANCE DOOR
D148	1.5	1.2	1.2	2.4	1	1.80		ENTRANCE DOOR
D149	1.5	1.2	1.2	2.4	1	1.80		ENTRANCE DOOR
D150								