

This is a "PROVISIONAL BUILDING PLAN" approved only for the purpose of inviting objections from the general public

Checked and found ok for Public Health (Internal) Service only subject to comments in forwarding letter to ACE(HQ) DL-43/1/21/6&7/7

Additional Chief Engineer (HQ) HSPV, Panchajanya

DDP (HQ) Member BPAC

P.A. A.T.P.

DDP (HQ) Member BPAC

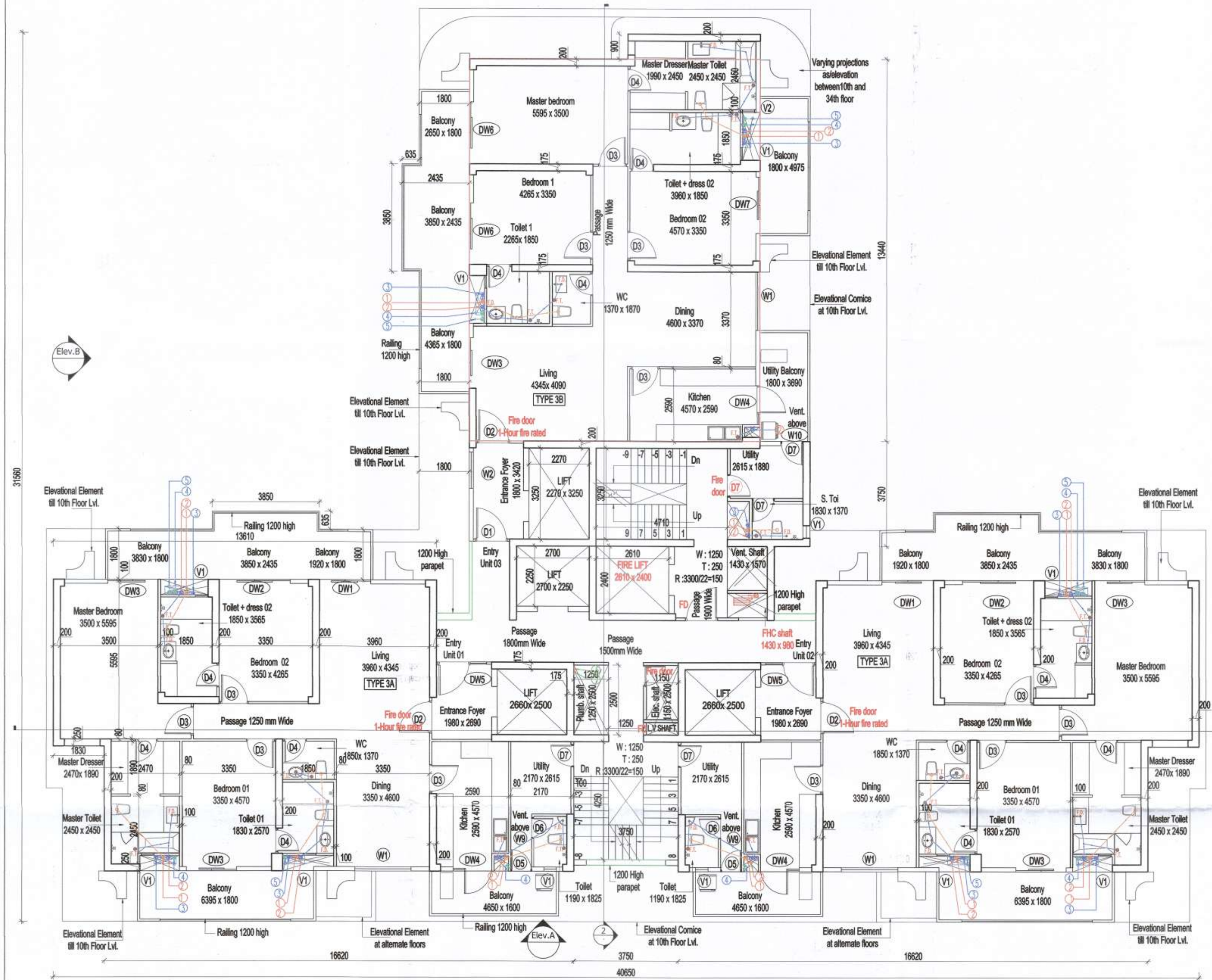

1 Typical floor plan (1st to 17th, 19th to 26th, 28th to 35th floor).
SCALE: 1:100

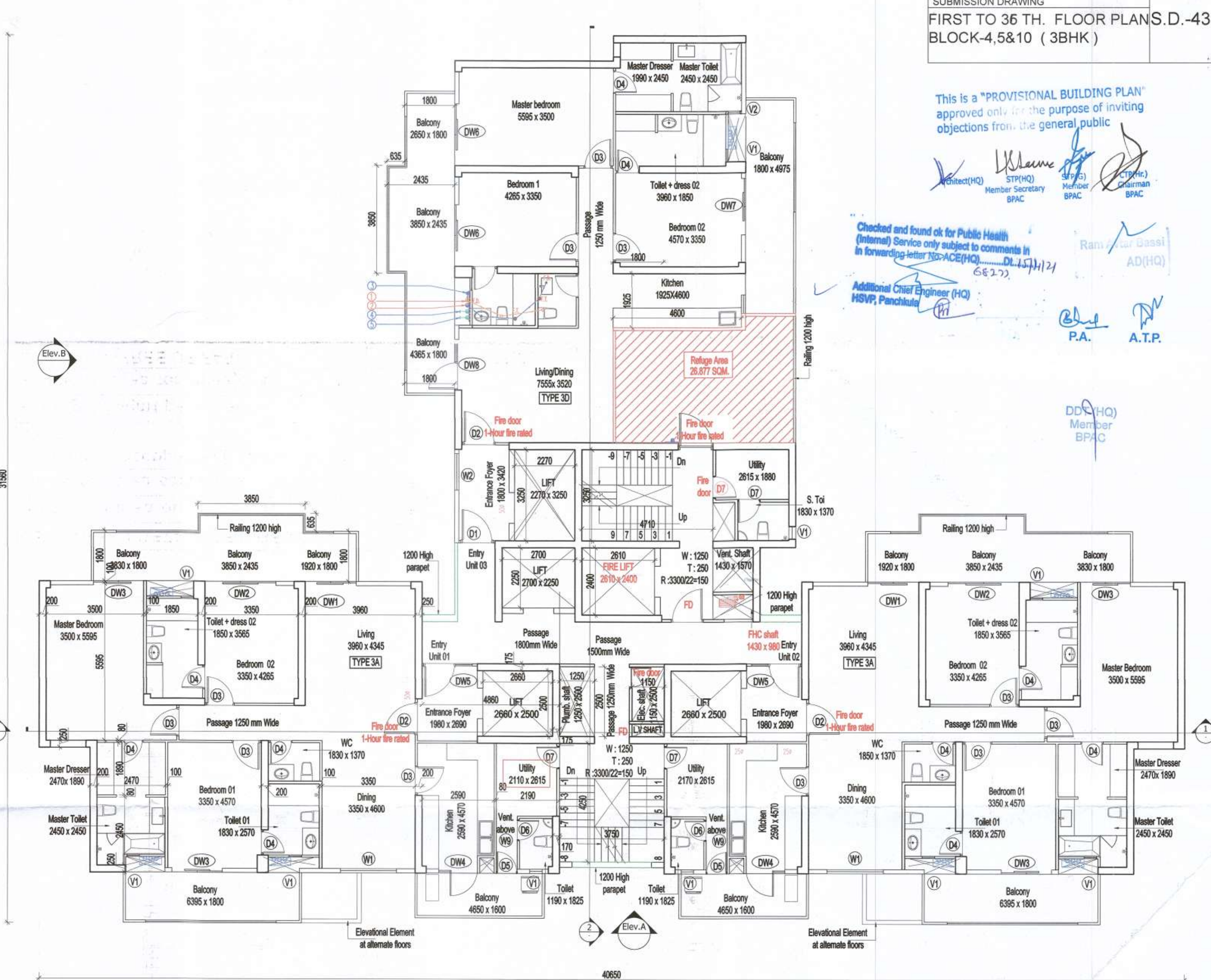

2 18th, 27th & 36th floor plan (Refuge floor).
SCALE: 1:100

LESS AREA 4 DETAIL (REFUGE AREA)		
Gross floor area on 18, 27 & 36 floor	=	534.585
for Refuge area calculation	=	1069.171
Total no. of occupants @ 12.5 sq.m per person	=	85.534
Area @ 0.3 sqmt per person	=	25.660
Additional area for wheelchair	=	0.900
LOCATION (FREE OF FAR)	=	26.560

LEGEND:-

	FIRE HOSE CABINET
	SIDE WALL SPRINKLER
	9 Ltr. WATER GAS PRESSURE TYPE FIRE EXTINGUISHER
	4.5 kg CO ₂ TYPE FIRE EXTINGUISHER
	SLUICE VALVE
	FLOW INDICATING SWITCH

NOTE:-
EACH FIRE HOSE CABINET SHALL CONSIST OF
1 No. - GUNMETAL SINGLE HEADED HYDRANT
2 Nos. - FIRE HOSES 63mm 15M LONG WITH
1 No. - SHORT BRANCH
1 No. - FIRST AID HOSE REEL
2 Nos. - FIRE EXTINGUISHERS
1 No. - FIRE MAN'S AXE

LEGEND:-

1	110 OD SWR PVC SOIL & VENT PIPE
2	110 OD SWR PVC WASTE & VENT PIPE
3	90 OD SWR PVC ANTI-SYPHONAGE PIPE
4	110 OD uPVC RAIN WATER PIPE (FOR BALCONY)
5	110 OD uPVC RAIN WATER PIPE (FOR TERRACE)
F.T.	FLOOR TRAP
F.D.	FLOOR DRAIN

DOOR/WINDOW SCHEDULE

SN.	Type	Width (mm)	Cill (mm)	Lintel (mm)	Height (mm)
1	D1	1150	+00	+2400	2400
2	D2	1150	+00	+2400	2400
3	D3	1000	+00	+2400	2400
4	D4	800	+00	+2400	2400
5	D5	750	+00	+2100	2100
6	D6	750	+00	+2100	2100
7	D7	800	+00	+2100	2100
8	W1	2020	+1000	+2650 (BOB)	1650
9	W2	1300	+1000	+2650 (BOB)	1650
10	W3	2000	+250	+2650 (BOB)	2400
11	W4	3180	+250	+2650 (BOB)	2400
12	W5	3200	+250	+2650 (BOB)	2400
13	W6	5440	+250	+2650 (BOB)	2400
14	W7	600	+1000	+2650 (BOB)	1650
15	W8	1000	+1000	+2100	1100
16	W9	750	+2100	+2650	550
17	W10	800	+2100	+2650	550
18	V1	450	+1350	+2400	1050
19	V2	430	+1350	+2400	1050
20	DW1	1840	+00	+2650 (BOB)	2650
21	DW2	2550	+00	+2650 (BOB)	2650
22	DW3	1800	+00	+2650 (BOB)	2650
23	DW4	1390	+00	+2100	2100
24	DW5	1750	+00	+2650 (BOB)	2650
25	DW6	2200	+00	+2650 (BOB)	2650
26	DW7	2020	+00	+2650 (BOB)	2650
27	DW8	1645	+00	+2650 (BOB)	2650

NOTE: TOWER 5 IS MIRROR OF TOWER 4 AND 10

PROJECT TITLE
REVISED BUILDING PLANS OF MIXED LAND USE UNDER TOD SCHEME FOR AREA MEASURING 19.244 ACRES (LICENCE NO. 168-172 OF 2004, DATED 16/12/2004 & LICENCE NO. 545-546 OF 2008, DATED 13/03/2006) IN SECTOR- 53, GURUGRAM MANESAR URBAN COMPLEX BEING DEVELOPED BY M/S VIPUL LIMITED AND OTHERS.

SCALE: 1:100
DATE: AUG. 2021
DEALT: SJ
CHECKED: MA

ARCHITECT
Design Axis architects
T-13A, AMB BAGH FARM HOUSE, NEAR SHAMSHI TALAB ANCHERA MOKH, MEHRAULI, NEW DELHI - 110030
PH - 9811068363, 26644831, 26648146
EMAIL - designaxis2015@gmail.com

ARCHITECT & ID
designcosmos
Architects & Interior Design Consultants
Second Floor, A-609, Sushant Lok-I, Gurgaon.
Email: studio.designcosmos@gmail.com
Contact: 0124-4203676

ARCHITECT'S SIGN.

APPLICANT'S SIGN.

For VIPUL LIMITED
Authorised Signatory